

D8001-5

D'SERIES SUBMERSIBLE PUMPS

Model DS / DVS / DL / DF

50Hz



D'SERIES SUBMERSIBLE PUMPS

For Sump, Effluent,
Waste water
and Sewage.

A comprehensive range
of Reliable, High quality
Submersible pumps.

Of Robust Cast iron
construction, with many
design features.

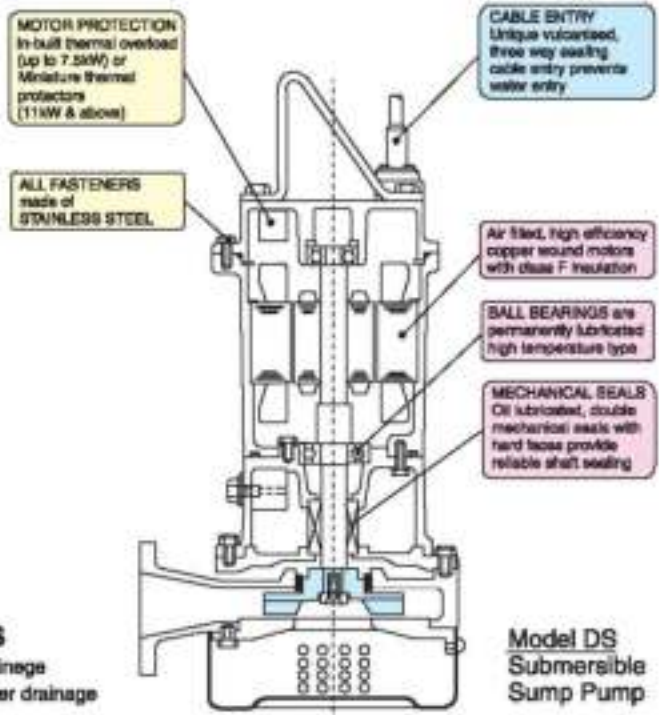

Model DS

■ FEATURES

- Efficient Semi-Open Impeller.
- Strainer prevents blockages.

■ APPLICATIONS

- Purification tank drainage
- Rain and spring water drainage
- Water supply

Model DVS

■ FEATURES

- Semi-Vortex Impeller offers non-clog operation and allows pumping of foreign matter up to 60-70% of discharge size.
- Easy Maintenance.

■ APPLICATIONS

- Ideal for waste water applications containing soft or fibrous solids
- Industrial waste water drainage
- Septic effluent
- Miscellaneous drainage

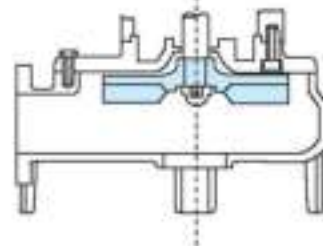

Model DL

■ FEATURES

- Non-Clog Semi-Open Impellers prevents clogging by fibrous matter.
- Full Range of Models up to 250 mm discharge size and 22 kW available.

■ APPLICATIONS

- Sewage
- Waste water

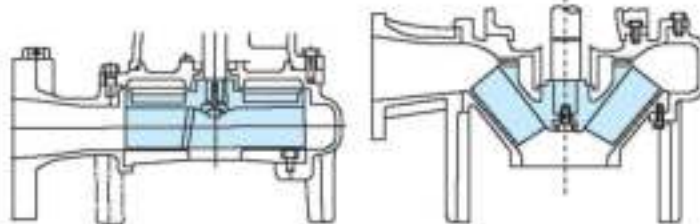

Model DF (with Cutter)

■ FEATURES

- Non-Clog Semi-Open Impellers prevents clogging by fibrous matter.
- Full Range of Models up to 100 mm discharge size and 3.7 kW available.

■ APPLICATIONS

- Sewage
- Waste water

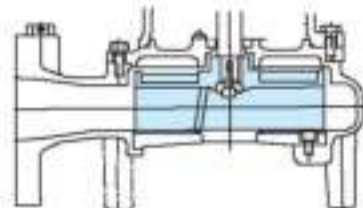

Specifications

| Description | | Pump | | | |
|---------------------|---|---|---|--|--|
| Model | DS | DVS | DL | DF (With Cutter) | |
| No. of Poles | 2 | 2 | 4 | 4 | |
| Liquid handled | Type of liquid | River water, Sewage | Sewage, Wash water | Sewage | |
| | Temperature | 0°C - 40°C for DS, DSA 0°C - 35°C for DSJ | 0°C - 40°C for DL, DLA 0°C - 35°C for DLJ | 0°C - 40°C for DF, DFA 0°C - 35°C for DFJ | |
| | Maximum solids size | 400µ - 3 mm, 500µ - 3mm, 600µ - 6mm, 800µ - 7 mm | 400µ - 25 mm, 500µ - 35 mm, 600µ - 45 mm | 500µ - 35 mm, 650µ - 40 mm, 800µ - 100 DCL, 40 mm, 1000µ - DLB, 57 MM, 1500µ - 60 mm, 2000µ - 70 mm, 2500µ - 75 mm. | 500µ - 35 mm, 650µ - 40 mm, 800µ - 46 mm, 1000µ - 57 mm |
| Maximum Submergence | 0.4 - 1.5 MW = 4 m, 2.2 - 3.7 MW = 8 m | 0.4 - 1.5 MW = 4 m, 2.2 - 3.7 MW = 8 m | 8 m | 8 m | |
| Minimum Submergence | Refer to water level (L.WL) in Dimensions | Refer to water level (L.WL) in Dimensions | Refer to water level (L.WL) in Dimensions | Refer to water level (L.WL) in Dimensions | |
| Synchronous speed | 3000 min ⁻¹ | 3000 min ⁻¹ | 1500 min ⁻¹ | 1500 min ⁻¹ | |
| Construction | Mechanical Seal | Double Mechanical Seal | Double Mechanical Seal | Double Mechanical Seal | |
| | Impeller | Semi-open | Semi-open | Semi-open, non-dog | |
| | Bearing | Pre-lubricated bearing | Pre-lubricated bearing | Pre-lubricated bearing | |
| Material | Casing | Cast Iron | Cast Iron | Cast Iron | |
| | Impeller | Cast Iron | Cast Iron | Cast Iron | |
| | Shaft | 403 Stainless Steel | 403 Stainless Steel | 403 Stainless Steel | |
| | Mechanical Impeller side | Silicon carbide vs Silicon carbide | Silicon carbide vs Silicon carbide | Silicon carbide vs Silicon carbide | |
| | Seal Motor side | Ceramic vs Carbon | Ceramic vs Carbon | Ceramic vs Carbon | |
| | Padding | NBR | NBR | NBR | NBR |
| Motor | | | | | |
| Type | 2 pole, air-filled watertight | 2 pole, air-filled watertight | 4 pole, air-filled watertight | 4 pole, air-filled watertight | |
| Protection | Class F | Class F | Class F | Class F | |
| Protection | Built in overload protector | Built in overload protector | Built in overload protector (up to 7.5 MW) | Built in temperature detector protection (11 - 22 MW) | |
| Accessories | | | | | |
| Standard | Special Companion Range cast iron with bolts: 40 - 50 DSS1.5. Submersible cable: 0.4 - 1.5 MW = 6 m, 2.2 - 3.7 MW = 10m. Float switch for DSA(DS) | Submersible cable: 0.4 - 1.5 MW = 6 m, 2.2 - 3.7 MW = 10m. Float switch for DLA, DLJ, DVA, DVJ, DFA, DFJ | Submersible cable: 0.4 - 1.5 MW = 6 m, 2.2 - 3.7 MW = 10m. Float switch for DLA, DLJ, DVA, DVJ, DFA, DFJ | Submersible cable: 0.4 - 1.5 MW = 6 m, 2.2 - 3.7 MW = 10m. Float switch for DLA, DLJ, DVA, DVJ, DFA, DFJ | |
| Optional | Quick discharge connector | Quick discharge connector | Quick discharge connector | Quick discharge connector | |

MODEL DS

SELECTION CHARTS

50 Hz (Synchronous speed 3000 min⁻¹)

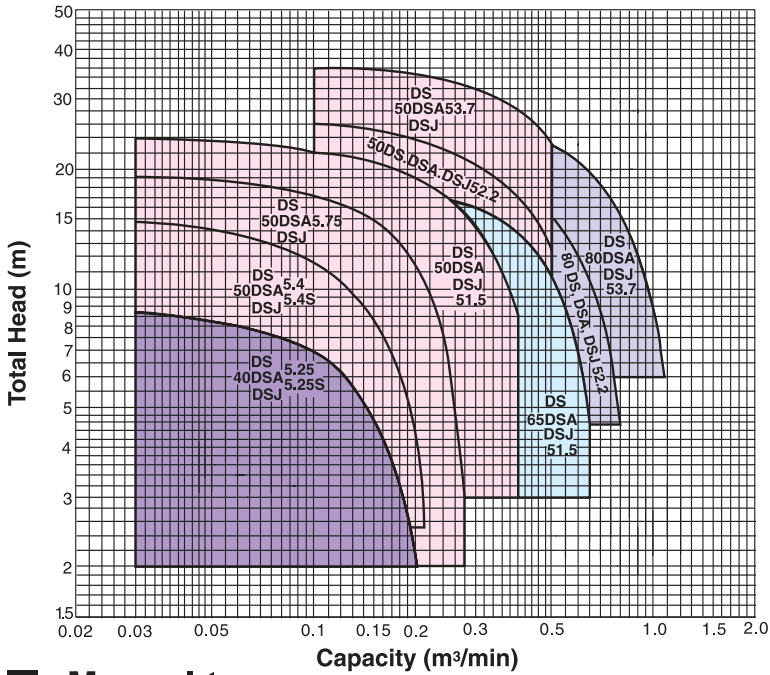

MODEL CODE

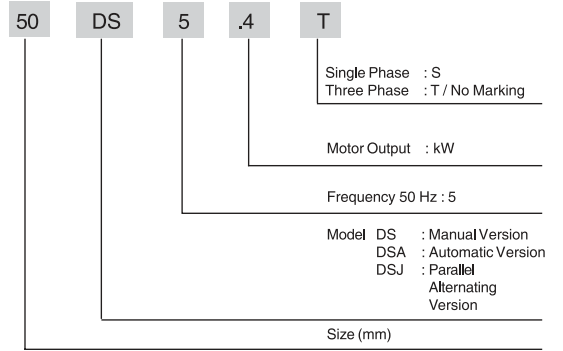

Manual type

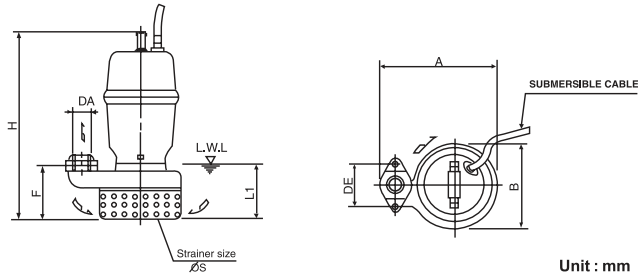

| Size Ø | Model | Out Put kW | Phase | Pump and Motor | | | | | | | Weight (Mass) kg |
|--------|-----------|------------|--------|----------------|-----|-----|-----|----|----|-----|------------------|
| | | | | A | B | F | H | DE | S | L1 | |
| 40 | 40DS5.25S | 0.25 | Single | 219 | 156 | 80 | 358 | 80 | 7 | 85 | 12 |
| | 40DS5.25 | 0.25 | Three | 219 | 156 | 80 | 358 | 80 | 7 | 85 | 12 |
| | 50DS5.4S | 0.4 | Single | 260 | 186 | 99 | 433 | 96 | 8 | 110 | 17 |
| 50 | 50DS5.4 | 0.4 | Three | 260 | 186 | 99 | 396 | 96 | 8 | 110 | 16 |
| | 50DS5.75 | 0.75 | Three | 260 | 186 | 99 | 396 | 96 | 8 | 110 | 17 |
| | 50DS5.15 | 1.5 | Three | 266 | 200 | 115 | 450 | 96 | 10 | 120 | 25 |

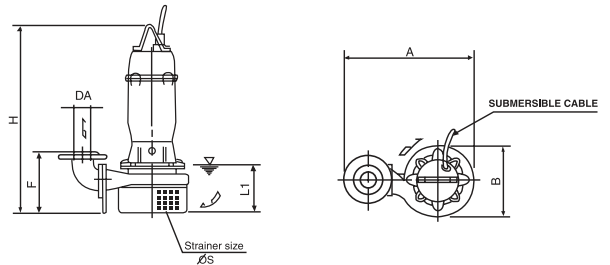

| Size Ø | Model | Out Put kW | Phase | Pump and Motor | | | | | | | Weight (Mass) kg |
|--------|-----------|------------|-------|----------------|-----|-----|-----|----|-----|----|------------------|
| | | | | A | B | F | H | S | L1 | | |
| 50 | 50DS5.2 | 2.2 | Three | 433 | 245 | 198 | 619 | 10 | 160 | 55 | |
| | 50DS5.3.7 | 3.7 | Three | 433 | 245 | 198 | 619 | 10 | 160 | 61 | |
| 65 | 65DS5.1.5 | 1.5 | Three | 407 | 210 | 197 | 503 | 10 | 120 | 35 | |
| 80 | 80DS5.2.2 | 2.2 | Three | 503 | 268 | 215 | 625 | 10 | 160 | 59 | |
| | 80DS5.3.7 | 3.7 | Three | 503 | 268 | 215 | 625 | 10 | 160 | 64 | |

Automatic type

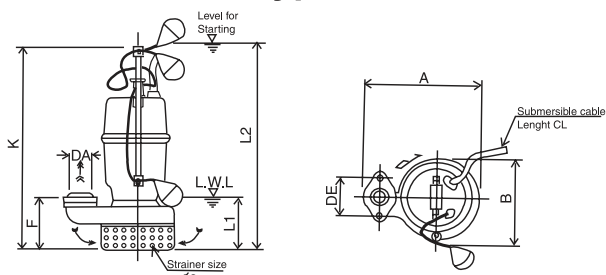

| Size Ø | Model | Out Put kW | Phase | Pump and Motor | | | | | | | Weight (Mass) kg | |
|--------|------------|------------|--------|----------------|-----|-----|----|----|-----|-----|------------------|----|
| | | | | A | B | F | DE | S | K | L1 | | L2 |
| 40 | 40DSA5.25S | 0.25 | Single | 219 | 185 | 80 | 80 | 7 | 530 | 150 | 490 | 13 |
| | 40DSA5.25 | 0.25 | Three | 219 | 185 | 80 | 80 | 7 | 530 | 150 | 490 | 13 |
| 50 | 50DSA5.4S | 0.4 | Single | 260 | 200 | 99 | 96 | 8 | 530 | 150 | 490 | 18 |
| | 50DSA5.4 | 0.4 | Three | 260 | 200 | 99 | 96 | 8 | 530 | 150 | 490 | 17 |
| | 50DSA5.75 | 0.75 | | 260 | 200 | 99 | 96 | 8 | 530 | 150 | 490 | 18 |
| | 50DSA5.1.5 | 1.5 | | 266 | 207 | 115 | 96 | 10 | 530 | 150 | 490 | 26 |

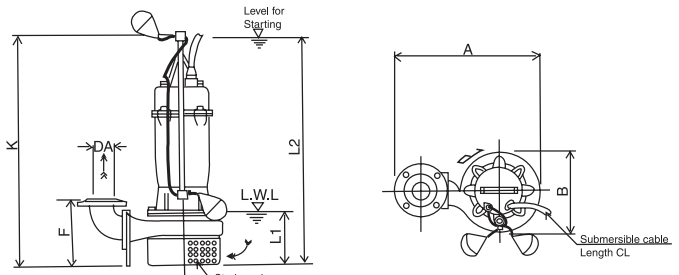

| Size Ø | Model | Out Put kW | Phase | Pump and Motor | | | | | | | Weight (Mass) kg |
|--------|------------|------------|-------|----------------|-----|-----|----|-----|-----|-----|------------------|
| | | | | A | B | F | S | K | L1 | L2 | |
| 50 | 50DSA5.2.2 | 2.2 | Three | 433 | 248 | 198 | 10 | 800 | 270 | 760 | 61 |
| | 50DSA5.3.7 | 3.7 | Three | 433 | 248 | 198 | 10 | 800 | 270 | 760 | 67 |
| 65 | 65DSA5.1.5 | 1.5 | Three | 407 | 210 | 197 | 10 | 530 | 150 | 490 | 36 |
| 80 | 80DSA5.2.2 | 2.2 | Three | 503 | 268 | 215 | 10 | 800 | 270 | 760 | 65 |
| | 80DSA5.3.7 | 3.7 | Three | 503 | 268 | 215 | 10 | 800 | 270 | 760 | 70 |

Parallel Alternate type

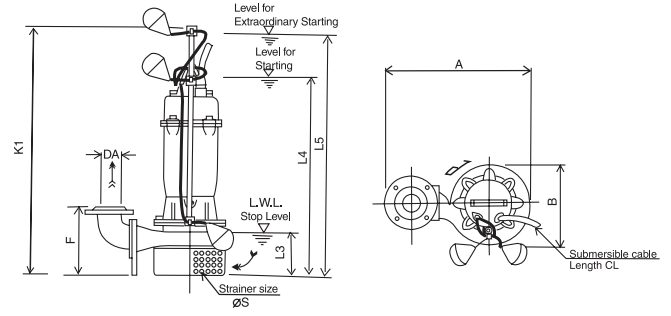
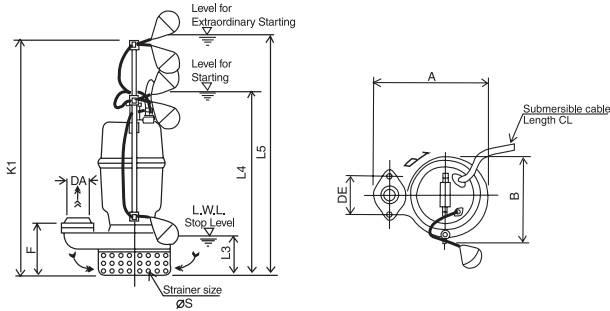

Unit : mm

| Size Ø | Model | Out Put kW | Phase | Pump and Motor | | | | | | | | Weight (Mass) kg | |
|-----------|------------|---------------|--------|----------------|-----|----|----|-----|-----|-----|-----|------------------------|----|
| | | | | A | B | F | DE | S | K1 | L3 | L4 | | L5 |
| 40 | 40DSJ5.25S | 0.25 | Single | 219 | 185 | 80 | 80 | 7 | 640 | 120 | 410 | 600 | 14 |
| | 40DSJ5.25 | 0.25 | Three | 219 | 185 | 80 | 80 | 7 | 640 | 120 | 410 | 600 | 14 |
| 50 | 50DSJ5.4S | 0.4 | Single | 260 | 200 | 99 | 96 | 8 | 640 | 120 | 410 | 600 | 18 |
| | 50DSJ5.4 | 0.4 | Three | 260 | 200 | 99 | 96 | 8 | 640 | 120 | 410 | 600 | 17 |
| | 50DSJ5.75 | 0.75 | | 260 | 200 | 99 | 96 | 8 | 640 | 120 | 410 | 600 | 18 |
| | 50DSJ5.15 | 1.5 | 268 | 207 | 115 | 96 | 10 | 640 | 120 | 410 | 600 | 27 | |

Unit : mm

| Size Ø | Model | Out Put kW | Phase | Pump and Motor | | | | | | | | Weight (Mass) kg |
|-----------|-----------|---------------|-------|----------------|-----|-----|----|-----|-----|-----|-----|------------------------|
| | | | | A | B | F | S | K1 | L3 | L4 | L5 | |
| 50 | 50DSJ52.2 | 2.2 | Three | 433 | 248 | 198 | 10 | 910 | 240 | 680 | 870 | 62 |
| | 50DSJ53.7 | 3.7 | Three | 433 | 248 | 198 | 10 | 910 | 240 | 680 | 870 | 67 |
| 65 | 65DSJ51.5 | 1.5 | Three | 407 | 210 | 197 | 10 | 640 | 120 | 410 | 600 | 36 |
| 80 | 80DSJ52.2 | 2.2 | Three | 503 | 268 | 215 | 10 | 910 | 240 | 680 | 870 | 65 |
| | 80DSJ53.7 | 3.7 | | 503 | 268 | 215 | 10 | 910 | 240 | 680 | 870 | 70 |

MODEL DVS

SELECTION CHARTS

50 Hz (Synchronous speed 3000 min⁻¹)

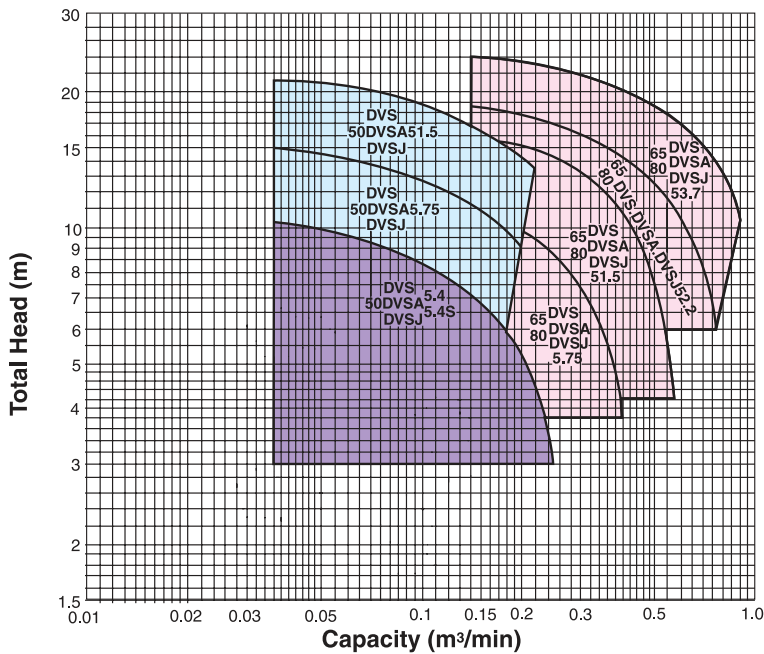

MODEL CODE

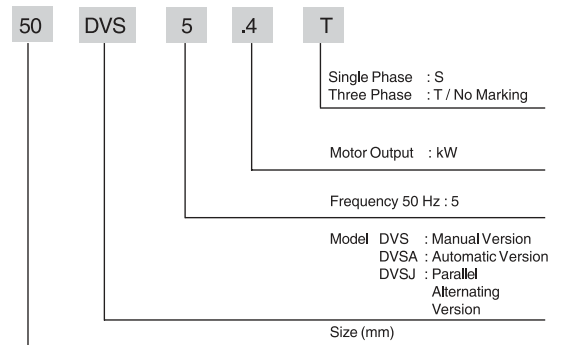

Manual type

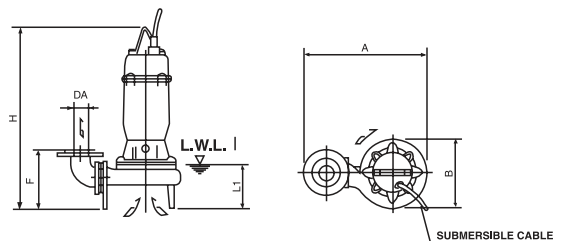
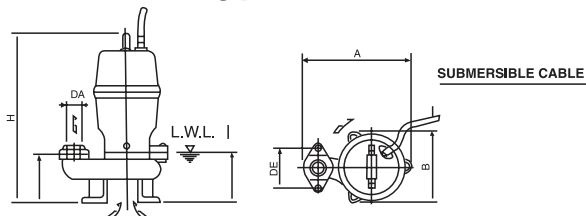

Unit : mm

| Size Ø | Model | Out Put kW | Phase | Pump and Motor | | | | | | Weight (Mass) kg |
|-----------|-----------|---------------|--------|----------------|-----|----|-----|----|-----|------------------------|
| | | | | A | B | F | H | DE | L1 | |
| 50 | 50DVS5.4S | 0.4 | Single | 239 | 160 | 82 | 435 | 96 | 105 | 18 |
| | 50DVS5.4 | 0.4 | Three | 239 | 160 | 82 | 398 | 96 | 105 | 17 |
| | 50DVS5.75 | 0.75 | Three | 249 | 171 | 82 | 400 | 96 | 105 | 19 |
| | 50DVS5.15 | 1.5 | Three | 249 | 171 | 82 | 440 | 96 | 105 | 19 |

Unit : mm

| Size Ø | Model | Out Put kW | Phase | Pump and Motor | | | | | Weight (Mass) kg |
|-----------|-----------|---------------|-------|----------------|-----|-----|-----|-----|------------------------|
| | | | | A | B | F | H | L1 | |
| 65 | 65DVS5.75 | 0.75 | Three | 396 | 195 | 178 | 503 | 125 | 25 |
| | 65DVS5.15 | 1.5 | | 396 | 195 | 178 | 521 | 125 | 24 |
| | 65DVS52.2 | 2.2 | | 427 | 227 | 201 | 643 | 155 | 50 |
| | 65DVS53.7 | 3.7 | | 427 | 227 | 201 | 643 | 155 | 59 |
| 80 | 80DVS5.75 | 0.75 | Three | 411 | 195 | 183 | 503 | 125 | 26 |
| | 80DVS5.15 | 1.5 | | 411 | 195 | 183 | 521 | 125 | 35 |
| | 80DVS52.2 | 2.2 | | 442 | 227 | 206 | 643 | 155 | 51 |
| | 80DVS53.7 | 3.7 | | 442 | 227 | 206 | 643 | 155 | 60 |

Automatic type

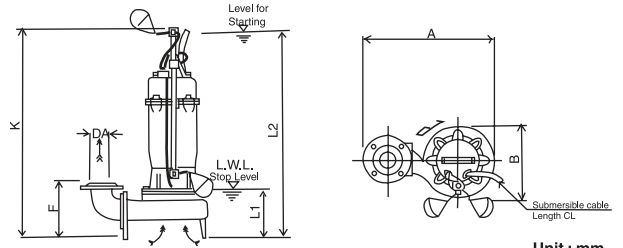
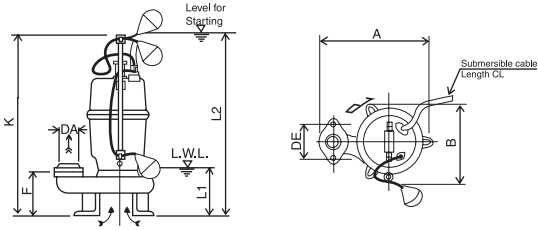

Unit : mm

| Size \varnothing | Model | Out Put kW | Phase | Pump and Motor | | | | | | | | Weight (Mass) kg |
|--------------------|-------------|------------|--------|----------------|-----|----|----|-----|-----|-----|----|------------------|
| | | | | A | B | F | DE | K | L1 | L2 | | |
| 50 | 50DVSA5.4S | 0.4 | Single | 239 | 183 | 82 | 96 | 530 | 150 | 490 | 20 | |
| | 50DVSA5.4 | 0.4 | Three | 239 | 183 | 82 | 96 | 530 | 150 | 490 | 18 | |
| | 50DVSA5.75 | 0.75 | Three | 249 | 197 | 82 | 96 | 530 | 150 | 490 | 20 | |
| | 50DVSA5.1.5 | 1.5 | Three | 249 | 201 | 82 | 96 | 530 | 150 | 490 | 30 | |

| Size \varnothing | Model | Out Put kW | Phase | Pump and Motor | | | | | | | | Weight (Mass) kg |
|--------------------|-------------|------------|-------|----------------|-----|-----|-----|-----|-----|-----|-----|------------------|
| | | | | A | B | F | H | J | K | L1 | L2 | |
| 65 | 65DVSA5.75 | 0.75 | Three | 396 | 206 | 178 | 540 | 145 | 530 | 150 | 490 | 26 |
| | 65DVSA5.1.5 | 1.5 | | 396 | 210 | 178 | 572 | 145 | 530 | 150 | 490 | 35 |
| | 65DVSA5.2.2 | 2.2 | | 427 | 237 | 201 | 736 | 160 | 770 | 250 | 730 | 51 |
| | 65DVSA5.3.7 | 3.7 | | 427 | 237 | 201 | 796 | 160 | 770 | 250 | 730 | 60 |
| 80 | 80DVSA5.75 | 0.75 | Three | 411 | 206 | 183 | 540 | 145 | 530 | 150 | 490 | 27 |
| | 80DVSA5.1.5 | 1.5 | | 411 | 210 | 183 | 572 | 145 | 530 | 150 | 490 | 36 |
| | 80DVSA5.2.2 | 2.2 | | 442 | 237 | 206 | 736 | 160 | 770 | 250 | 730 | 52 |
| | 80DVSA5.3.7 | 3.7 | | 442 | 237 | 206 | 736 | 160 | 770 | 250 | 730 | 61 |

Parallel Alternate type

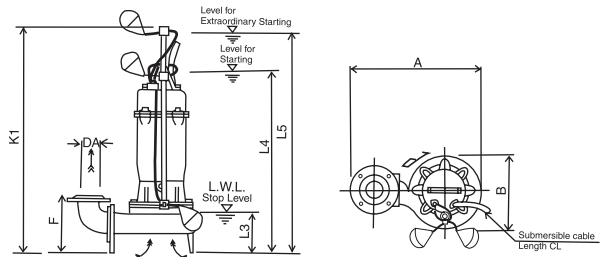
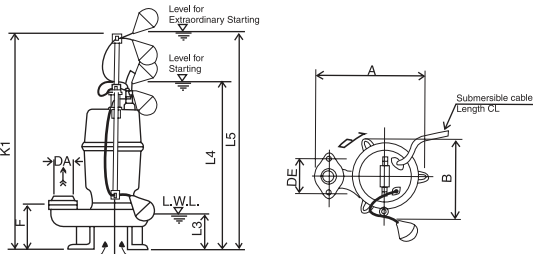

Unit : mm

| Size \varnothing | Model | Out Put kW | Phase | Pump and Motor | | | | | | | | Weight (Mass) kg |
|--------------------|-------------|------------|--------|----------------|-----|----|----|-----|-----|-----|-----|------------------|
| | | | | A | B | F | DE | K1 | L3 | L4 | L5 | |
| 50 | 50DVSJ5.4S | 0.4 | Single | 239 | 183 | 82 | 96 | 530 | 120 | 410 | 600 | 20 |
| | 50DVSJ5.4 | 0.4 | Three | 239 | 183 | 82 | 96 | 530 | 120 | 410 | 600 | 19 |
| | 50DVSJ5.75 | 0.75 | Three | 249 | 197 | 82 | 96 | 530 | 120 | 410 | 600 | 20 |
| | 50DVSJ5.1.5 | 1.5 | Three | 249 | 201 | 82 | 96 | 530 | 120 | 410 | 600 | 30 |

| Size \varnothing | Model | Out Put kW | Phase | Pump and Motor | | | | | | | | Weight (Mass) kg |
|--------------------|-------------|------------|-------|----------------|-----|-----|-----|-----|-----|-----|----|------------------|
| | | | | A | B | F | K1 | L3 | L4 | L5 | | |
| 65 | 65DVSJ5.75 | 0.75 | Three | 396 | 206 | 178 | 640 | 120 | 410 | 600 | 26 | |
| | 65DVSJ5.1.5 | 1.5 | | 396 | 210 | 178 | 640 | 120 | 410 | 600 | 35 | |
| | 65DVSJ5.2.2 | 2.2 | | 427 | 237 | 201 | 880 | 220 | 650 | 840 | 51 | |
| | 65DVSJ5.3.7 | 3.7 | | 427 | 237 | 201 | 880 | 220 | 650 | 840 | 60 | |
| 80 | 80DVSJ5.75 | 0.75 | Three | 411 | 206 | 183 | 640 | 120 | 410 | 600 | 27 | |
| | 80DVSJ5.1.5 | 1.5 | | 411 | 210 | 183 | 640 | 120 | 410 | 600 | 36 | |
| | 80DVSJ5.2.2 | 2.2 | | 442 | 237 | 206 | 880 | 220 | 650 | 840 | 52 | |
| | 80DVSJ5.3.7 | 3.7 | | 442 | 237 | 206 | 880 | 220 | 650 | 840 | 61 | |

MODEL DL

SELECTION CHARTS

50 Hz (Synchronous speed 1500 min⁻¹)

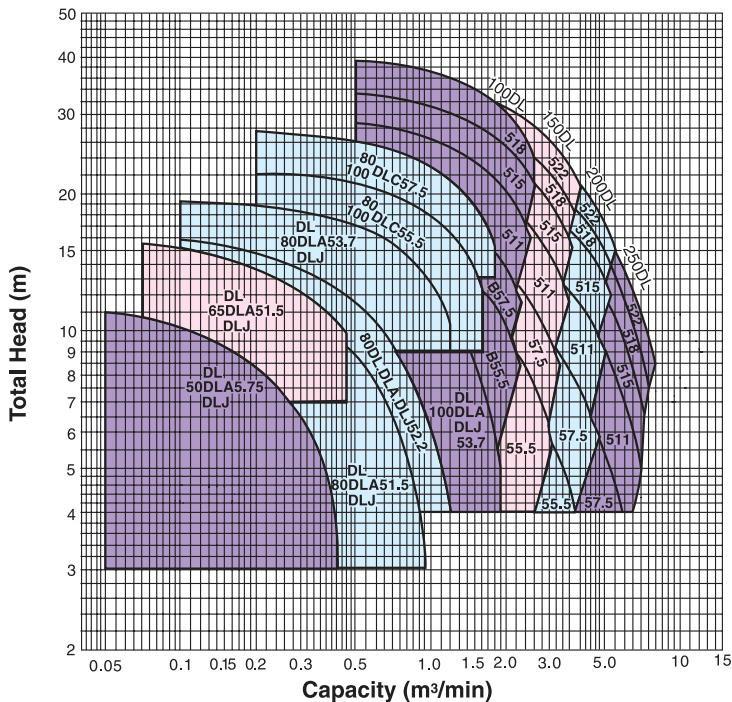

MODEL CODE

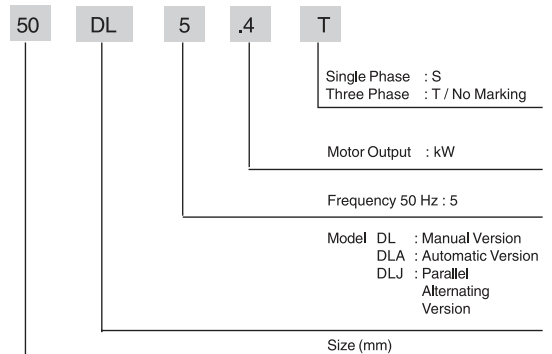

Manual type

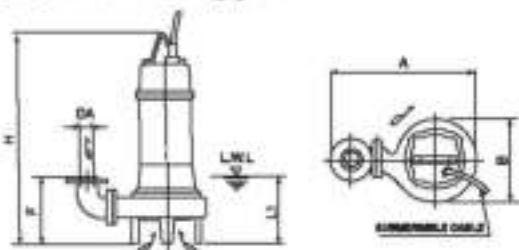

Unit mm

| Size ∅ | Model | Output kW | Pump and Motor | | | | | Weight (Mass) kg |
|-----------|----------|--------------|----------------|-----|-----|------|-----|------------------------|
| | | | A | B | F | H | L1 | |
| 50 | 50DL5.75 | 0.75 | 411 | 239 | 175 | 590 | 100 | 34 |
| 65 | 65DL1.5 | 1.5 | 487 | 291 | 200 | 678 | 140 | 52 |
| | 65DL1.5 | 1.5 | 524 | 292 | 220 | 687 | 188 | 55 |
| 80 | 80DL2.2 | 2.2 | 542 | 308 | 220 | 684 | 185 | 67 |
| | 80DL3.7 | 3.7 | 567 | 328 | 220 | 687 | 188 | 75 |
| | 100DL3.7 | 3.7 | 614 | 335 | 250 | 728 | 208 | 79 |
| 100 | 100DL5.7 | 5.7 | 614 | 335 | 250 | 728 | 208 | 120 |
| | 100DL5.5 | 5.5 | 660 | 399 | 320 | 757 | 208 | 124 |
| | 100DL5.5 | 5.5 | 660 | 399 | 320 | 757 | 208 | 141 |
| | 100DL7.5 | 7.5 | 680 | 399 | 320 | 790 | 208 | 148 |
| | 100DL11 | 11 | 701 | 400 | 320 | 858 | 208 | 180 |
| | 100DL15 | 15 | 741 | 441 | 300 | 854 | 208 | 230 |
| | 100DL18 | 18.5 | 741 | 441 | 300 | 858 | 208 | 285 |
| 150 | 150DL5.5 | 5.5 | 760 | 398 | 381 | 798 | 245 | 148 |
| | 150DL7.5 | 7.5 | 760 | 418 | 377 | 783 | 245 | 160 |
| | 150DL11 | 11 | 810 | 438 | 377 | 882 | 245 | 180 |
| | 150DL15 | 15 | 810 | 438 | 377 | 871 | 245 | 230 |
| | 150DL18 | 18.5 | 848 | 476 | 381 | 879 | 245 | 300 |
| | 150DL22 | 22 | 848 | 476 | 381 | 879 | 245 | 325 |
| 200 | 200DL5.5 | 5.5 | 852 | 430 | 414 | 825 | 285 | 180 |
| | 200DL7.5 | 7.5 | 860 | 463 | 410 | 808 | 285 | 178 |
| | 200DL11 | 11 | 880 | 463 | 410 | 867 | 285 | 212 |
| | 200DL15 | 15 | 908 | 479 | 411 | 904 | 285 | 280 |
| | 200DL18 | 18.5 | 932 | 512 | 418 | 1001 | 285 | 308 |
| 250 | 250DL22 | 22 | 950 | 512 | 418 | 1001 | 285 | 350 |
| | 250DL7.5 | 7.5 | 968 | 525 | 420 | 903 | 400 | 260 |
| | 250DL11 | 11 | 980 | 541 | 424 | 898 | 400 | 320 |
| | 250DL15 | 15 | 1007 | 549 | 448 | 1081 | 400 | 380 |
| | 250DL18 | 18.5 | 1007 | 549 | 448 | 1081 | 400 | 420 |
| | 250DL22 | 22 | 1007 | 549 | 548 | 1081 | 400 | 440 |

Automatic type

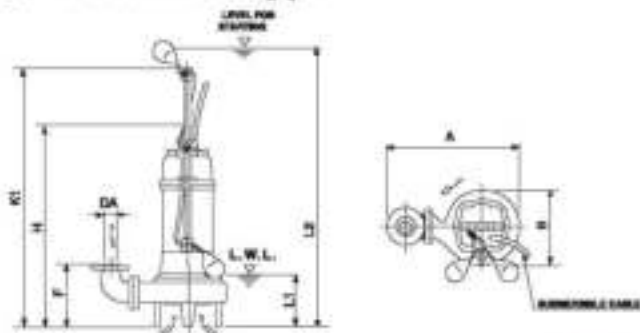

Unit mm

| Size ∅ | Model | Output kW | Pump and Motor | | | | | Weight (Mass) kg | |
|-----------|-----------|--------------|----------------|-----|-----|-----|-----|------------------------|----|
| | | | A | B | F | K | L1 | | L2 |
| 50 | 50DLA5.75 | 0.75 | 411 | 239 | 175 | 630 | 250 | 650 | 35 |
| 65 | 65DLA5.5 | 1.5 | 487 | 291 | 200 | 840 | 320 | 860 | 55 |
| 80 | 80DLA5.5 | 1.5 | 524 | 292 | 220 | 840 | 320 | 860 | 58 |
| | 80DLA2.2 | 2.2 | 542 | 308 | 220 | 840 | 320 | 860 | 70 |
| | 80DLA3.7 | 3.7 | 567 | 328 | 220 | 840 | 320 | 860 | 78 |
| 100 | 100DLA3.7 | 3.7 | 614 | 335 | 250 | 840 | 320 | 860 | 85 |

Parallel Alternate type

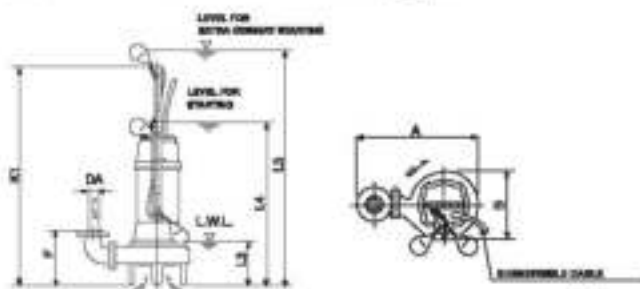

Unit mm

| Size ∅ | Model | Output kW | Pump and Motor | | | | | | Weight (Mass) kg | |
|-----------|-----------|--------------|----------------|-----|-----|-----|-----|-----|------------------------|----|
| | | | A | B | F | K1 | L3 | L4 | | L5 |
| 50 | 50DLA5.75 | 0.75 | 411 | 239 | 175 | 740 | 220 | 570 | 780 | 36 |
| 65 | 65DLA1.5 | 1.5 | 487 | 291 | 200 | 950 | 290 | 780 | 970 | 55 |
| | 65DLA1.5 | 1.5 | 524 | 292 | 220 | 950 | 290 | 780 | 970 | 58 |
| 80 | 80DLA2.2 | 2.2 | 542 | 308 | 220 | 950 | 290 | 780 | 970 | 70 |
| | 80DLA3.7 | 3.7 | 567 | 328 | 220 | 950 | 290 | 780 | 970 | 78 |
| | 100DLA3.7 | 3.7 | 614 | 335 | 250 | 850 | 290 | 780 | 970 | 85 |

MODEL DF (With Currtter)

SELECTION CHARTS

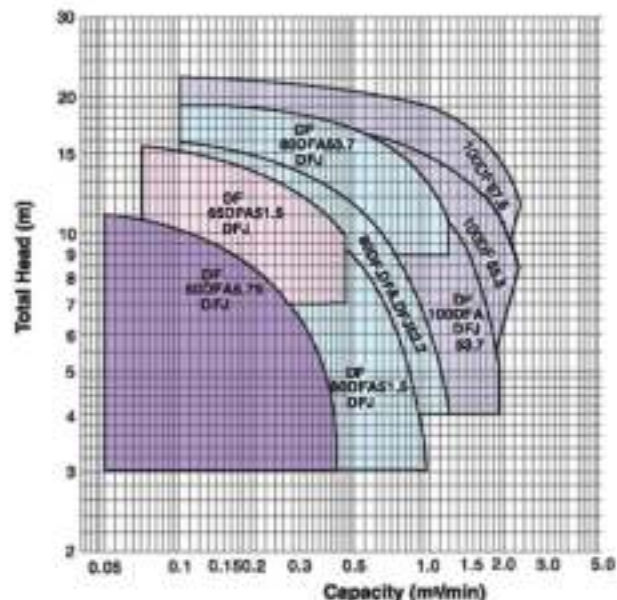

MODEL CODE

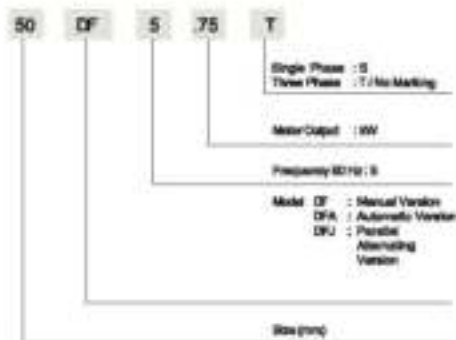

Manual type

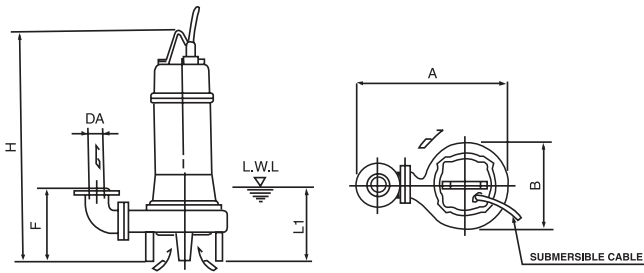

Automatic type

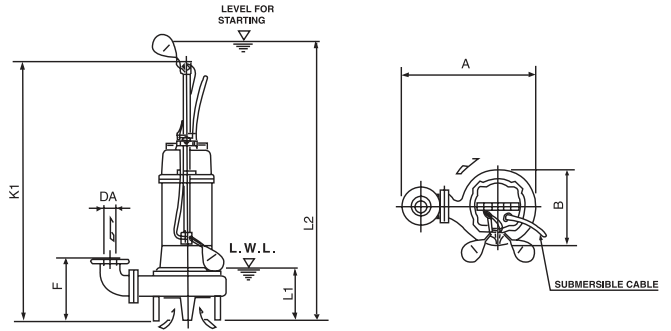

Unit mm

| Size Ø | Model | Output kW | Pump and Motor | | | | | Weight (Mass) kg |
|-----------|-----------|--------------|----------------|-----|-----|-----|-----|------------------------|
| | | | A | B | F | H | L1 | |
| 50 | 50DF5.75 | 0.75 | 411 | 239 | 175 | 510 | 120 | 34 |
| 65 | 65DF51.5 | 1.5 | 497 | 291 | 200 | 576 | 140 | 52 |
| | 80DF51.5 | 1.5 | 524 | 292 | 220 | 597 | 165 | 55 |
| 80 | 80DF52.2 | 2.2 | 542 | 308 | 220 | 654 | 165 | 67 |
| | 80DF53.7 | 3.7 | 567 | 328 | 220 | 687 | 165 | 75 |
| | 100DF53.7 | 3.7 | 614 | 335 | 250 | 705 | 185 | 79 |
| 100 | 100DF55.5 | 5.5 | 646 | 369 | 323 | 767 | 205 | 123 |
| | 100DF57.5 | 7.5 | 673 | 385 | 323 | 759 | 205 | 141 |

Unit mm

| Size Ø | Model | Output kW | Pump and Motor | | | | | | Weight (Mass) kg |
|-----------|------------|--------------|----------------|-----|-----|-----|-----|-----|------------------------|
| | | | A | B | F | K | L1 | L2 | |
| 50 | 50DFA5.75 | 0.75 | 411 | 239 | 175 | 630 | 250 | 650 | 36 |
| 65 | 65DFA51.5 | 1.5 | 497 | 291 | 200 | 840 | 320 | 860 | 55 |
| 80 | 80DFA51.5 | 1.5 | 524 | 292 | 220 | 840 | 320 | 860 | 58 |
| | 80DFA52.2 | 2.2 | 542 | 308 | 220 | 840 | 320 | 860 | 70 |
| | 80DFA53.7 | 3.7 | 567 | 328 | 220 | 840 | 320 | 860 | 78 |
| 100 | 100DFA53.7 | 3.7 | 614 | 335 | 250 | 840 | 320 | 860 | 85 |

Parallel Alternate type

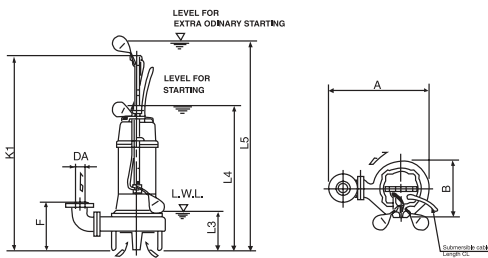

Unit mm

| Size Ø | Model | Output kW | Pump and Motor | | | | | | | Weight (Mass) kg |
|-----------|------------|--------------|----------------|-----|-----|-----|-----|-----|-----|------------------------|
| | | | A | B | F | K1 | L3 | L4 | L5 | |
| 50 | 50DFJ5.75 | 0.75 | 411 | 239 | 175 | 740 | 220 | 570 | 760 | 36 |
| 65 | 65DFJ51.5 | 1.5 | 497 | 291 | 200 | 950 | 290 | 780 | 970 | 55 |
| 80 | 80DFJ51.5 | 1.5 | 524 | 292 | 220 | 950 | 290 | 780 | 970 | 58 |
| | 80DFJ52.2 | 2.2 | 542 | 308 | 220 | 950 | 290 | 780 | 970 | 70 |
| | 80DFJ53.7 | 3.7 | 567 | 328 | 220 | 950 | 290 | 780 | 970 | 78 |
| 100 | 100DFJ53.7 | 3.7 | 614 | 335 | 250 | 950 | 290 | 780 | 970 | 85 |

Flange Dimension type

Flange

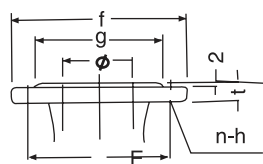

Unit: mm

| Ø | e | f | g | t | n | h |
|-----|-----|-----|-----|----|----|----|
| 50 | 120 | 155 | 100 | 18 | 4 | 15 |
| 65 | 140 | 175 | 120 | 18 | 4 | 15 |
| 80 | 150 | 185 | 130 | 18 | 8 | 15 |
| 100 | 175 | 210 | 155 | 20 | 8 | 15 |
| 150 | 240 | 280 | 215 | 22 | 8 | 19 |
| 200 | 290 | 330 | 265 | 24 | 12 | 19 |
| 250 | 355 | 400 | 325 | 30 | 12 | 25 |
| 300 | 400 | 445 | 370 | 32 | 16 | 25 |

OPTIONS

■ AUTOMATIC OPERATION (A', J' TYPE)

All models up to 3.7kW are available as automatic (A' type) or parallel alternating (J' type) pumps with inbuilt control devices and float switches. There is no need for an external control panel, and operation can begin as soon as the pumps are installed and connected to a power source.

SINGLE PUMP INSTALLATION (A' TYPE)

A single automatic (A' type) pump is installed in the sump.

The pump automatically starts when the water level in the sump reaches the 'start level', and stops when the pump has lowered the water level to the 'stop level'.

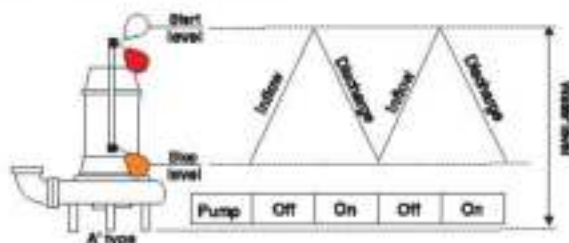

DUPLEX PUMP INSTALLATION (A' & J' TYPE)

Two pumps, one A' type and one J' type are installed in the sump. In normal operating conditions, operation alternates between the two pumps. In times of extraordinary inflow (inflow is greater than the capacity of a single pump), then the two pumps will operate together in parallel operation.

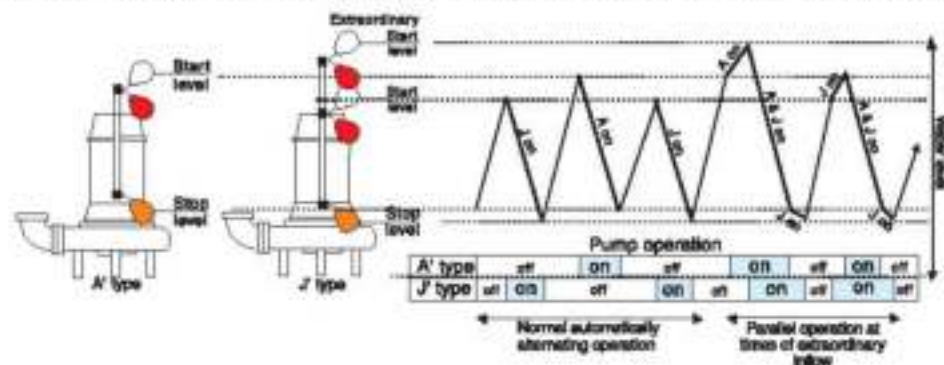

■ QUICK DISCHARGE CONNECTION (QDC)

An optional quick discharge connector is available to suit all Ebara D-series submersible pumps, allowing easy removal and replacement of the pumps for maintenance purposes without having to enter the sump.

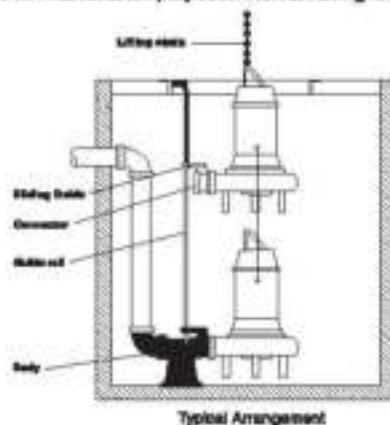

Note: (1) Full details of the A' type, J' type and QDC dimensions are available in the respective model's Technical Data.
(2) All measurements subject to change without prior notice.

■ FLOAT SWITCH

| FLOAT SWITCH | |
|---------------------|--------------------------|
| Model | COL024080 A |
| Temperature | 0-50°C |
| Function of contact | Up = ON Down = OFF |
| Voltage | AC 24V DC 24 V |
| Max Current | AC 0.5A DC 0.5A |
| Contact Capacity | AC 10 VA DC 10 VA |
| Lead Wire | 2x0.2mm ² x6m |



EBARA CORPORATION

| | | |
|-------------------------------|------------------------|----------------------|
| Head Office, Tokyo | Phone: 81-3-3743-6111 | |
| International Division, Tokyo | Phone: 81-3-5481-6111 | |
| Singapore Office | Phone: 65-862-3536 | Fax: 65-861-0598 |
| Beijing Office | Phone: 86-10-8590-8150 | Fax: 86-10-8590-8158 |
| Bangkok Office | Phone: 66-2-216-4935 | Fax: 66-2-216-4937 |
| Hanoi Office | Phone: 84-4-826-2601 | Fax: 84-4-826-2617 |
| Jakarta Office | Phone: 62-21-8740852 | Fax: 62-21-8740033 |
| Kuala Lumpur Office | Phone: 603-5069-8655 | Fax: 603-5069-3766 |
| Manila Office | Phone: 63-2-816-7524 | Fax: 63-2-817-6662 |
| Taipei Office | Phone: 886-2-567-1310 | Fax: 886-2-567-1046 |
| Dubai Office | Phone: 971-4-883-8889 | Fax: 971-4-883-5307 |

Distributor / Dealer